



The Ridings, Ealing, London W5 3BT
Price: £1,700,000 Freehold

An extended, detached 6-bedroom Haymills sun-trap residence with accommodation over three floors and enjoying an east / west aspect with fantastic views from the upper floor.

The accommodation comprises entrance hall, office, 3 reception rooms, cloakroom, kitchen, breakfast room, store area, utility room, basement store room, 6 bedrooms, 2 bathrooms (1 en suite), wet room and a conservatory with French windows to roof terrace.

There is a front garden with forecourt parking and an east/west-facing rear garden with fantastic views from the upper floor.

Total approx floor area 360.6 sq m / 3882 sq ft.

Situated in the favoured **Hanger Hill East (Haymills Estate)** a conservation area, with access to **Park Royal, North Ealing, West Acton** and **Hanger Lane** stations and local shopping facilities, **Ealing Broadway** station with Elizabeth Line connection & town centre and the M4 & M40 motorways. Well-placed for a number of local schools including Montpelier & St Gregory's Primaries, St Augustine's Priory, The Japanese School, West Acton Primary, Twyford CofE High, Ada Lovelace CofE High and Ellen Wilkinson High.





The Ridings, London, W5

Approximate Area = 3882 sq ft / 360.6 sq m

For identification only - Not to scale



Grimshaw & Co



Grimshaw & Co



Grimshaw & Co

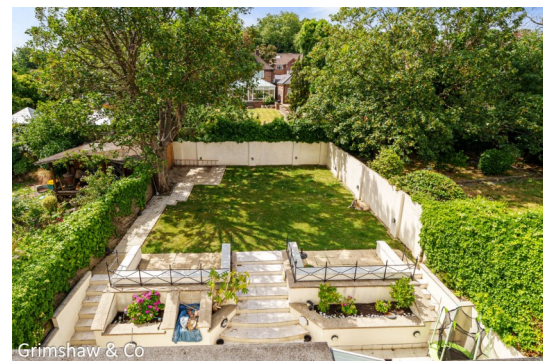

Grimshaw & Co

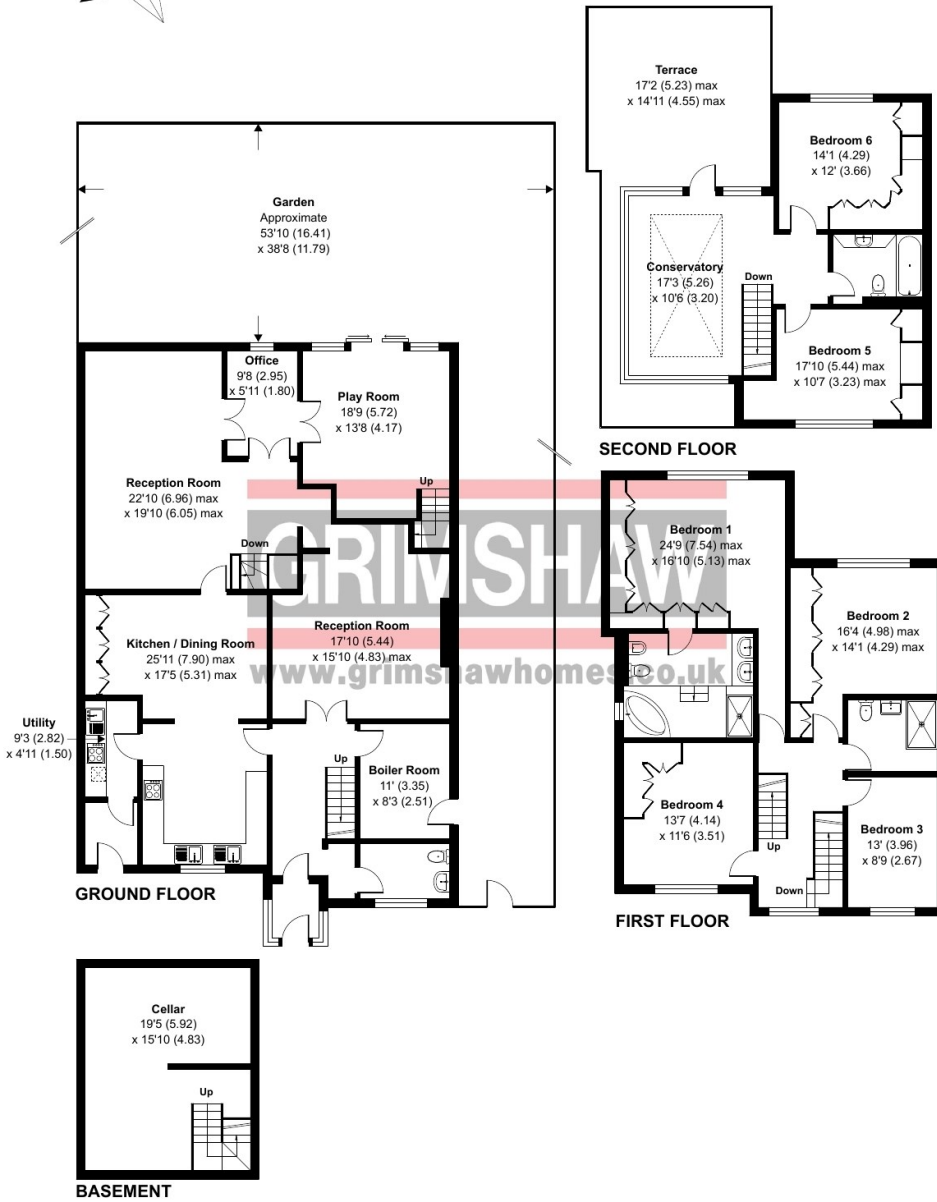

Certified Property Measurer
Floor plan produced in accordance with RICS Property Measurement Standards incorporating International Property Measurement Standards (IPMS2 Residential). © nchecom 2023. Produced for Grimshaw & Co. REF: 1005892

EPC Rating = D
Council tax band = G (subject to confirmation)

VIEWING BY APPOINTMENT - All negotiations should be conducted through Grimshaw & Company, who will be pleased to arrange appointments and provide further information.

Any reference to the term "period" denotes period-style. Services, heating, appliances, any security and drainage systems have not been tested. Internal photographs are reproduced for general information only and it must not be inferred that any item shown therein is included with the property. Where double-glazing is mentioned, it must not be inferred that each and every door and window in the property is double-glazed. Trade Names: Where trade names are mentioned, you are advised to verify these with the vendor to your own satisfaction. All property measurements are approximate and have been taken with an electronic tape into bays and alcoves as appropriate. These particulars do not form part of any offer or contract nor can their accuracy be relied upon by purchasers, who should satisfy themselves by inspection or otherwise. Neither Grimshaw & Company nor any person in their employment has any authority to make or give any warranty whatever in relation to any property. No responsibility can be accepted for any loss of expenses incurred in viewing in relation to any property.

27.02.2024 Ref: 9701

Grimshaw and Co, 5 Station Parade, Ealing Common, London W5 3LD

