



Edendale, Creswick Road, Acton, London W3 9HB
Price: £379,950 Leasehold - No Chain

Situated in a pleasant road, within easy reach of both **West Acton** station with local shopping facilities and **Acton Main Line** station with Elizabeth Line connection and local shops. The lovely open space of Springfield Gardens is nearby. With access to **Ealing Broadway** station also with Elizabeth Line & town centre. Road connections for the M4 & M40 motorways. Well-placed for local schools including West Acton Primary, St Vincent's RC Primary, The Japanese School, Derwentwater Primary, Ark Soane Academy and Twyford CofE High.

A 2-bedroom ground-floor flat in need of some updating with maintained communal gardens.

The accommodation comprises entrance hall, reception room, kitchen, 2 bedrooms and a bathroom.

Total approx floor area 66.6 sq m / 717 sq ft.



Edendale, Creswick Road, London, W3

Approximate Area = 717 sq ft / 66.6 sq m

For Identification only - Not to scale

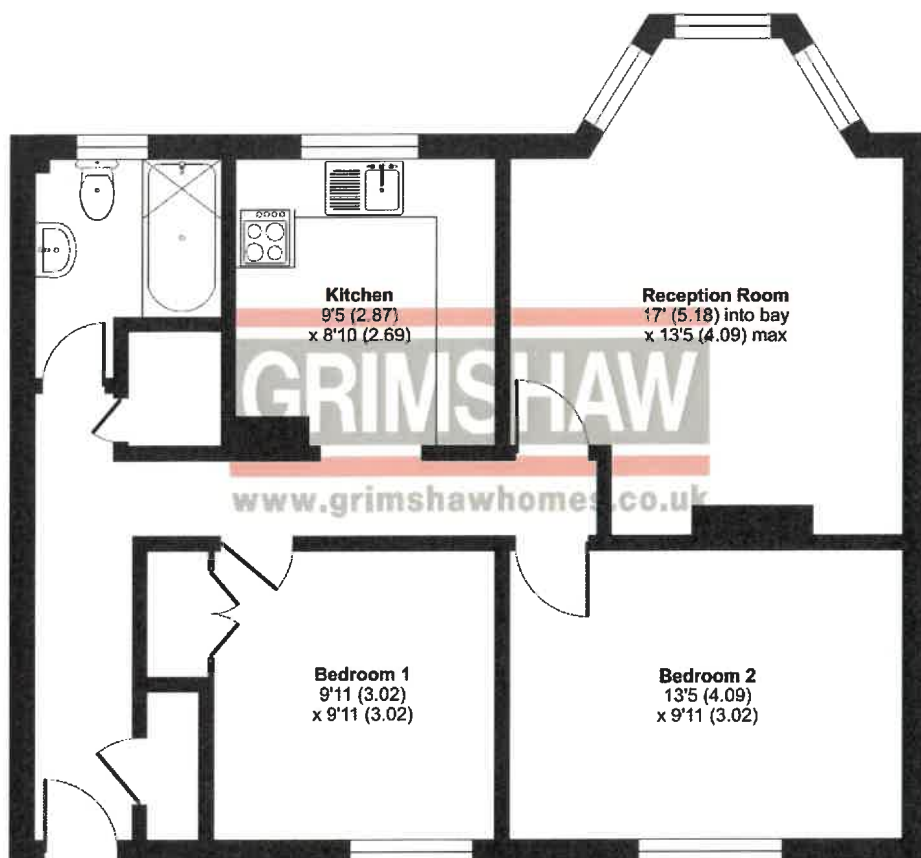

GROUND FLOOR



RICS Certified Property Measurer
Floor plan produced in accordance with RICS Property Measurement Standards incorporating International Property Measurement Standards (IPMS2 Residential). © nichecom 2023.
Produced for Grimshaw & Co. REF: 980098

Lease: 89 years (subject to confirmation)

Service Charge: £98 per calendar month (subject to confirmation)

Ground Rent to be confirmed

EPC Rating = C

Council tax band = C (subject to confirmation)

VIEWING BY APPOINTMENT - All negotiations should be conducted through Grimshaw & Company, who will be pleased to arrange appointments and provide further information.

Any reference to the term "period" denotes period-style. Services, heating, appliances, any security and drainage systems have not been tested. Internal photographs are reproduced for general information only and it must not be inferred that any item shown therein is included with the property. Where double-glazing is mentioned, it must not be inferred that each and every door and window in the property is double-glazed. Trade Names: Where trade names are mentioned, you are advised to verify these with the vendor to your own satisfaction. All property measurements are approximate and have been taken with an electronic tape into bays and alcoves as appropriate. These particulars do not form part of any offer or contract nor can their accuracy be relied upon by purchasers, who should satisfy themselves by inspection or otherwise. Neither Grimshaw & Company nor any person in their employment has any authority to make or give any warranty whatever in relation to any property. No responsibility can be accepted for any loss of expenses incurred in viewing in relation to any property.

08.06.2023 Ref: 9717

Grimshaw and Co, 5 Station Parade, Ealing Common, London W5 3LD

GRIMSHAW
www.grimshawhomes.co.uk